

Couplings

Type KB1



Stock photo

Document-/Rev.-No.:

TR-V-TI-GB-0420 v04

05/26/2025

Advantages

- Backlash-free miniature metal bellows coupling with side grub screws
- Easy installation
- High torsional rigidity
- Vibration damping
- Compensation of shaft misalignment with minimal restoring forces
- Ideal metal bellows coupling for rotary encoders

Description

The metal bellows couplings were specially developed for use in systems with high-precision measuring and control devices, such as rotary encoders. Thanks to the exceptional softness of the electroformed metal bellows, only low spring forces act on the bearings. This minimizes mechanical stresses caused by misalignment of the shafts and increases the service life of the system. At the same time, vibrations are dampened. The high torsional rigidity of the metal bellows coupling enables virtually loss-free and very accurate mechanical transmission of information.

Hub with adjusting screw

The hubs with adjusting screws are designed for applications that do not require precise mounting adjustment. The clamping screws spaced at 120° ensure that the closing forces are perfectly balanced. However, in the event of vibrations, it may be necessary to use a thread lock or self-locking screws.

Subject to change.

Couplings

Type KB1

Document-/Rev.-No.:

TR-V-TI-GB-0420 v04

05/26/2025

Drawing

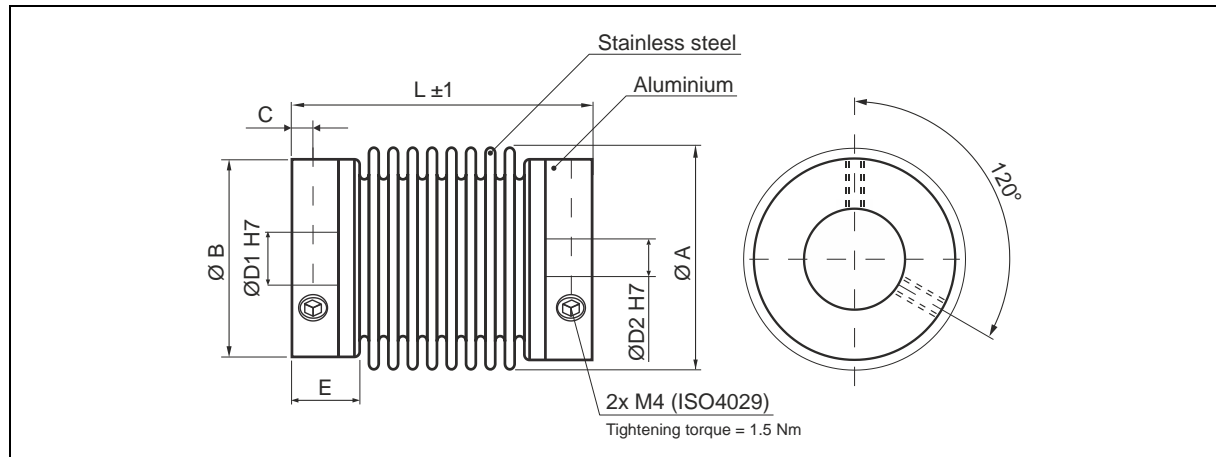

Dimensions [mm]

Type	L	Ø A	Ø B	C	E
	Length	Outer diameter	Hub diameter		Hub length
KB1 20/32	32	24	21.5	3	6
KB1 15/30	30	19	19	3	8

Type	Ø D1/D2 [mm]	Articelo no.
KB1 20/32	6/6	34000073
	6/10	34000007
	8/8	34000074
	8/10	34000175
	10/10	34000008
	10/12	34000019
12/12	34000009	

Type	Ø D1/D2 [mm]	Articelo no.
KB1 15/30	6/6	34000222
	6/10	34000065
	10/10	34000018

Technical Data

Type	Torque	Mass	Mass inertia	Spring stiffness			Offset		
	TKN [Nm]	[g]	J [g cm ²]	torsion CT [Nm/rad]	radial CR [N/mm]	axial CA [N/mm]	radial ΔKr [mm]	axial ΔKa [mm]	angle ΔKw [°] degree
KB1 20/32	2	15	13.5	1050	11	9	0.25	0.5	2
KB1 15/30	1.5	12	7.4	700	20	9	0.15	0.4	2

Speed max. [min ⁻¹]	Temperature range [°C]
15 000	-30 ~ 120

Subject to change.